

TO LET

TAKE-AWAY/RESTAURANT, RETAIL

BANK HOUSE CORNMARKET, D8



FULLY FITTED RETAIL/HOT FOOD UNIT
APPROX. 160 m²

- ☛ Fully fitted high profile corner unit at busy location close to Christchurch, Temple Bar, the National College of Art & Design & the proposed Digital Hub.
- ☛ Full planning permission for hot food and straight retail use allowing for a wide variety of uses including take-away / restaurant, convenience, showroom and off licence

The logo for Hooke & Macdonald Commercial, featuring a stylized red and yellow graphic to the left of the company name.

HOOKE & MACDONALD
COMMERCIAL

01 6318 403

HIGH PROFILE UNIT TO LET



Location

Ideally located next to Farrow & Ball, at the junction of Bridge Street, Thomas Street and High Street, this high profile unit is a unique opportunity to acquire a property right in the heart of Dublin City Centre. It is prominently situated between the landmark Christchurch Cathedral and the National College of Art and Design. Existing occupiers within close proximity include Jurys Inn Christchurch, The Four Courts and all the established occupants of the desirable Temple Bar area.

Description

Extending to approximately 160 m², the unit has dual frontage to both Cornmarket and Augustine Street. The premises was fitted out to a very high standard in 2006. This fit-out includes marble tiled floors and suspended ceilings with inset directional lighting and air-conditioning units. There is 'pay & display' car parking directly in front of the unit.

The unit has full planning permission for straight retail use and hot food take-away / restaurant use.

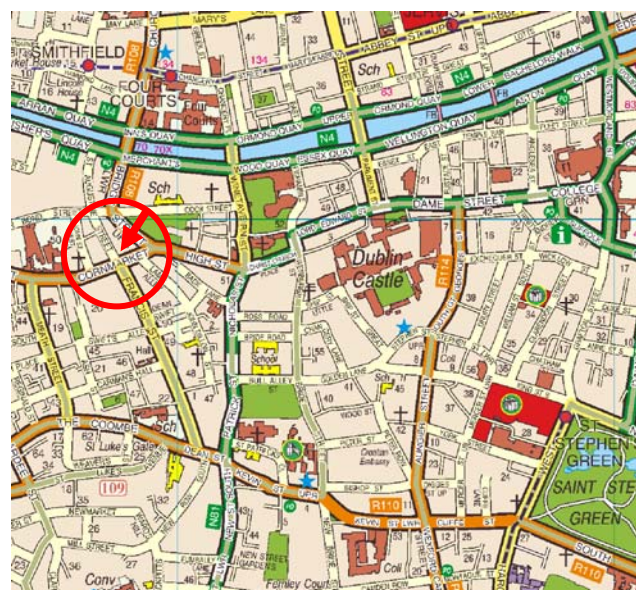
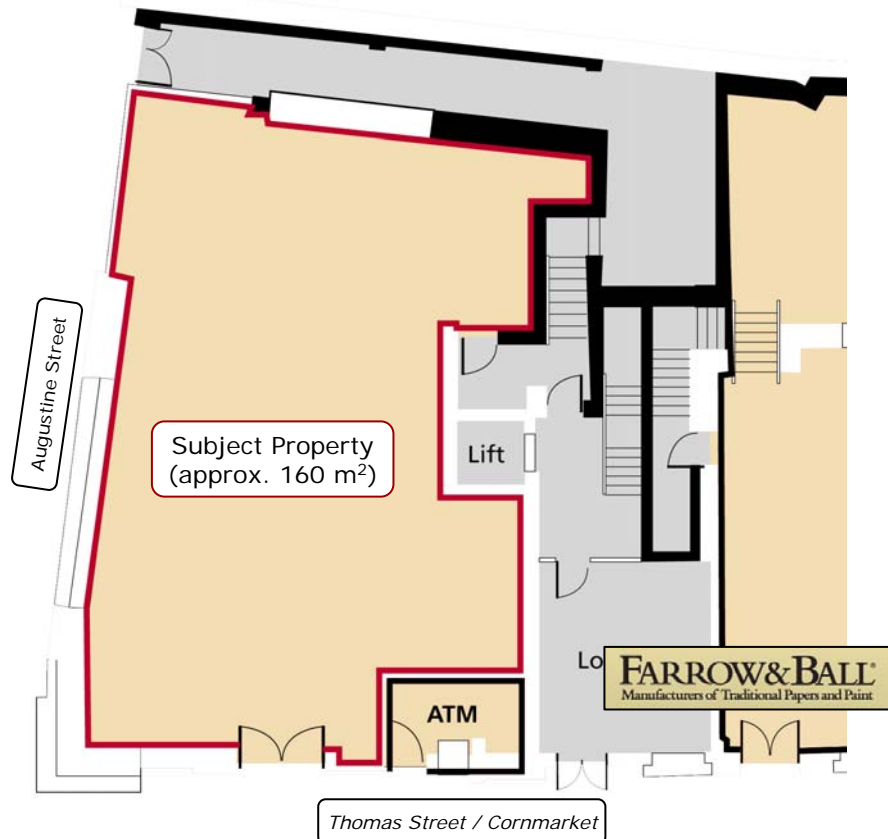

Terms

The property is available to let on flexible new lease terms. Quoting terms are available on request.

Viewing

For further information or to arrange a viewing please contact Enda Moore or Gavin Hanlon at Hooke & MacDonald Commercial Tel 6318403



118 Lr. Baggot Street, Dublin 2

Tel: 01-631 8403 Fax: 01-661 6318

E-mail: commercial@hookemacdonald.ie

www.hookemacdonald.ie